

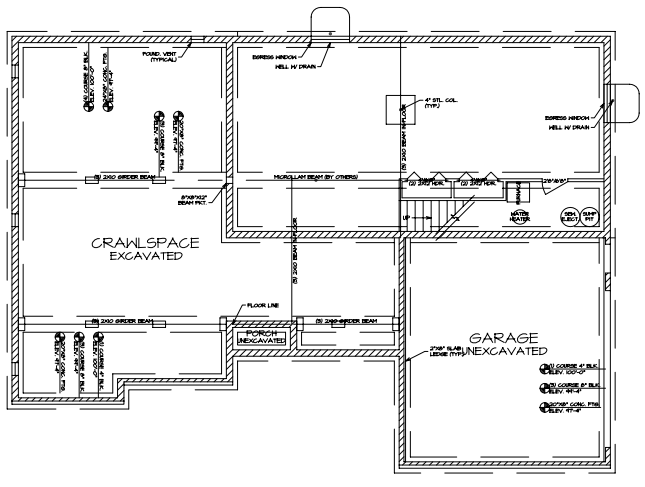

FRONT ELEVATION  
A-1 SCALE: 1/4"=1'-0"



FOUNDATION PLAN  
A-3 SCALE: 1/4"=1'-0"

- FOUNDATION PLAN NOTES:**
1. ALL CONCRETE SHALL BE 3000 PSI COMPRESSIVE STRENGTH.
  2. ALL CONCRETE SHALL BE CAST WITH 4% STEEL FIBERS.
  3. ALL CONCRETE SHALL BE CAST WITH 1/2\"/>

STATISTICS:	
AREA:	EXISTING: PROPOSED:
FIRST FLOOR AREA:	N/A 1,882 S.F.
SECOND FLOOR AREA:	N/A 521 S.F.
TOTAL LIVING AREA:	N/A 2,403 S.F.
BASEMENT AREA:	N/A 840 S.F.
GARAGE AREA:	N/A 524 S.F.
TOTAL AREA:	N/A 3,767 S.F.

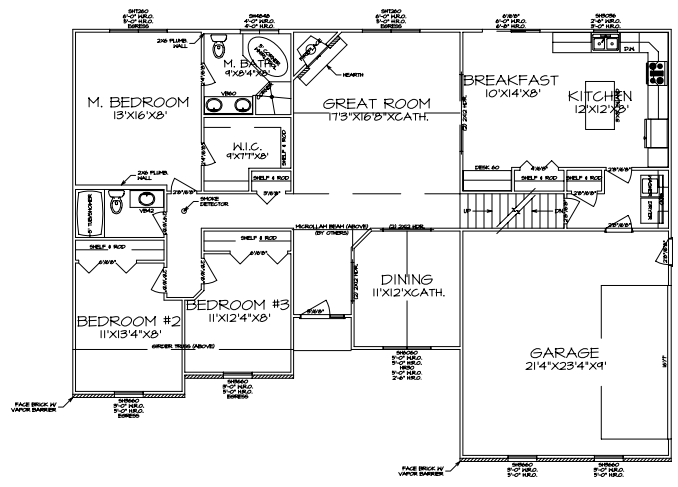

FIRST FLOOR PLAN  
A-4 SCALE: 1/4"=1'-0"

- FLOOR PLAN NOTES:**
1. ALL CONCRETE SHALL BE 3000 PSI COMPRESSIVE STRENGTH.
  2. ALL CONCRETE SHALL BE CAST WITH 4% STEEL FIBERS.
  3. ALL CONCRETE SHALL BE CAST WITH 1/2\"/>

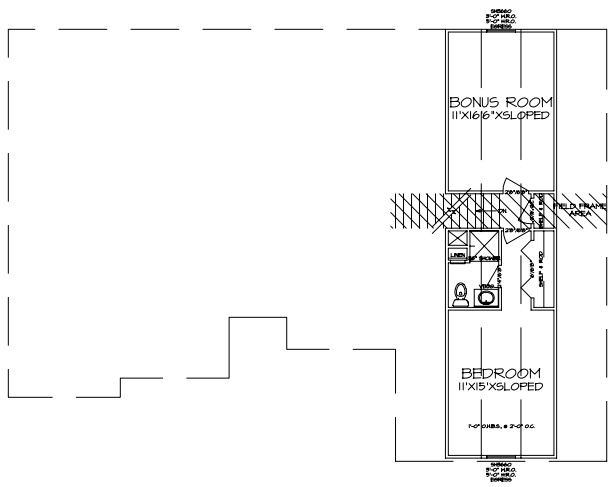

SEC. FLOOR PLAN  
A-5 SCALE: 1/4"=1'-0"

- FLOOR PLAN NOTES:**
1. ALL CONCRETE SHALL BE 3000 PSI COMPRESSIVE STRENGTH.
  2. ALL CONCRETE SHALL BE CAST WITH 4% STEEL FIBERS.
  3. ALL CONCRETE SHALL BE CAST WITH 1/2\"/>